

Insertable sensor NiCr-Ni with round mounting plug T 820-6

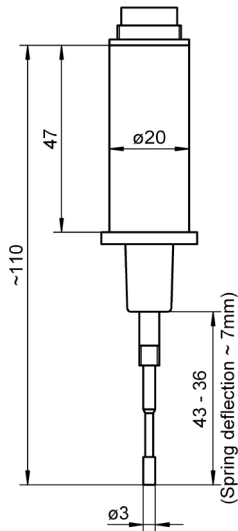

Operative range:

Measuring tip, spring-loaded, for surface and immersion measurement.

Accessories:

ALMEMO® connecting cable, 2 meters Order no. ZA9020BK2

Technical data

Accuracy:	NiCr-Ni class 2*
Measuring tip	Operative range -40 to +400 °C Silver rivet, level, spring-loaded not electrically isolated
T ₉₀ *	3 s
Insert length	60 mm (see layout drawing)
Fixture	Plastic, Ø 20 mm, resistant up to +120 °C
Connection	Round mounting plug

Types

Insertable sensor NiCr-Ni
with round mounting plug

Order no.

FT98206

Insertable sensor NiCr-Ni with terminal head FT 0477

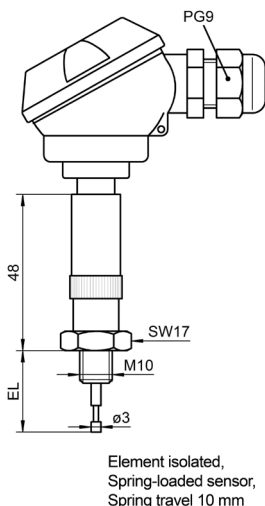

Operative range:

Spring-loaded measuring tip, for surface and immersion measurement

Options:

3-meter compensation line PVC, mounted, free ends:
Order no. OT9020K02L0030
ALMEMO® plug including assembly for NiCr-Ni-sensor
Order no. OT9020AS

Technical data:

Accuracy:	NiCr-Ni class 2*
Measuring tip:	Operative range -40 to +400°C Silver rivet, level, spring-loaded, electronically isolated
Thread:	M10
Insert length:	25 mm (see layout drawing)
Terminal head:	Clamp connector

Types

Screw-in sensor NiCr-Ni
with terminal head

Order no.

FT0477

* Range of validity see page 07.03

Temperature

Insertable sensor Pt100 with terminal head FP 0463

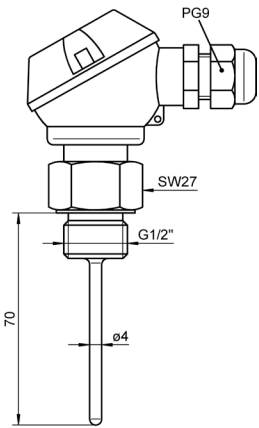

Operative range:

For immersion measurements, pressure-sealed up to 15 bar.

Options:

3 meters cable PVC, assembled, free ends
OT9030K02L0030
ALMEMO® connector including assembly for Pt100 sensor
OT9030AS

Technical data

Accuracy:	Pt100 film resistor, class B*
Sensor tube	Stainless steel
Operative range:	-40...+350°C
Thread	1/2", with copper ring seal, pressure-sealed up to 15 bar
Insert length	70 mm (see layout drawing)
Terminal head	Clamp connector

Variants	Order no.
Insertable sensor with terminal head	FP0463

Screw-in sensor Pt100, NiCr-Ni with fitted cable Fx 0710 L27M10

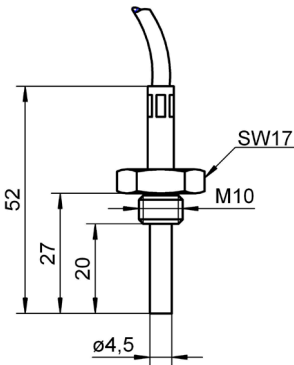

Operative range:

For immersion measurement

Option:

ALMEMO® connector including assembly for Pt100 sensors:
Order no. OT9030AS

Technical data FP0710L27M10

Accuracy:	Pt100 film resistor, class B*
Sensor material:	stainless steel
Operative range:	-40 to +200 °C
Thread:	M10
Insert length:	27 mm (see layout drawing)
Cable:	3 meters, FEP / wire shielding, / FEP free ends

Variants	Order no.
Screw-in sensor Pt100 with cable, free ends	FP0710L27M10
Option cable length 5 meters	OPK04L0050

Technical data FT0710L27M10

Accuracy:	NiCr-Ni class 2*
Sensor material:	stainless steel
Operative range:	-100 to +400 °C
Thread:	M10
Insert length:	27 mm (see layout drawing)
Cable:	3 meters, thermal line glass filament / glass filament / VA wire shielding, free ends

Variants	Order no.
Screw-in sensor NiCr-Ni with cable, free ends	FT0710L27M10
Option cable length 5 meters	OTK06L0050

* Range of validity see page 07.03

DAkkS or factory calibration KT90xx temperature for sensor or measuring chain (sensor + device) (see chapter Calibration certificates)
DAkkS calibration meets all the requirements regarding test resources laid down in DIN EN ISO/IEC 17025.

Insertable sensor PtRh-Pt (S) with terminal head FT 0425

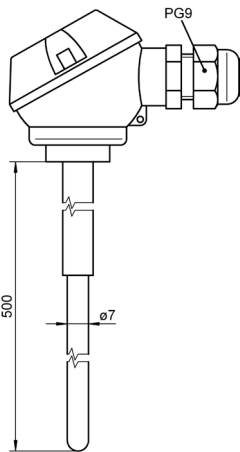

Operative range:

For immersion measurements, up to 1400 or 1600 °C.

Technical data

Accuracy:	Thermowire PtRh-Pt (S) class 1*
Measuring tip	Ceramic tube see under variants
Operative range	see under variants
Insert length	500 mm
Protective tube	Ceramic, replaceable, 7 x 1 mm
Cable	2-meter compensation line silicone insulation, free ends

Accessories

Ceramic protective tube for T04251 Order no. ZB9425SR1

Ceramic protective tube for FT04252 Order no. ZB9425SR2

Options

ALMEMO® connector with assembly Order no. OT9020AS

Variants

Insertable sensor PtRh-Pt type S with terminal head and compensation lines, free ends)

$T_{max} = 1400^{\circ}\text{C}$, element- $\varnothing = 0.35$ mm, ceramic 610

FT04251

$T_{max} = 1600^{\circ}\text{C}$, element- $\varnothing = 0.5$ mm, ceramic 710

FT04252

* Range of validity see page 07.03